

**KEY**

**BOUNDARY DESCRIPTION: (1800 Acres)**

Beginning from a point located 200 feet west of the San Lorenzo River at the southern state park boundary in Section 24, proceeding northerly at 200 feet from and parallel to the San Lorenzo River until it reaches the intersect of Craig Springs Creek; then it continues easterly at 200 feet north of and parallel to Craig Springs Creek to a point 50 feet west of the Saratoga Gap Trail; it crosses the creek to the south and at the intersect of the Ridge Trail continues east and north to an intersect of the Service Road Trail; from here the boundary continues east at 50 feet south of the edge of the road to the state park boundary along State Highway 35, then south for 1000 feet parallel to the highway and 40 feet west of its shoulder; from this point the boundary generally follows the tree line easterly and southerly to the intersect of the Ridge Trail; then continues west 50 feet from and parallel to the trail on its north side, along the connector trail to the intersect of the Saratoga Gap Trail; it continues south and easterly 50 feet from and parallel to the Saratoga Gap Trail to Castle Rock Falls; from this point the boundary generally follows the 2640 feet contour line for approximately 2500 feet, then continues northeast to the state park boundary; at a distance of 50 feet inside the state park boundary, it continues south approximately 1000 feet and then parallel to the Kings Creek Truck Trail and state park boundary (excluding the orchards) until it intersects with the southern state park boundary between Sections 29 and 30; then continues north and west parallel to and 50 feet inside the state park boundary to its terminus across the San Lorenzo River.

- LEGEND**
- PARK AREA
  - NATURAL PRESERVE
  - STATE PARK BOUNDARY
  - PRIMARY HIGHWAY
  - PAVED ROAD
  - UNIMPROVED ROADS
  - INTERMITTENT STREAMS
  - TRAILS

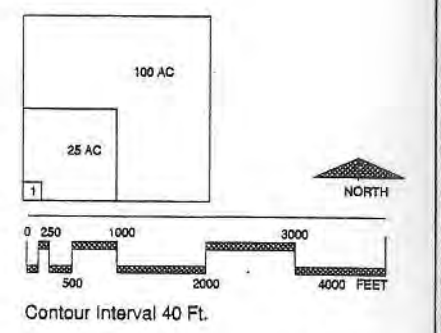

**PROPOSED  
 NATURAL  
 PRESERVE**

DESIGNED D. Keck	DATE	REVISIONS	APPROVED	DATE
DRAWN D. Ambrogis				
CHECKED D. Keck				
RESOURCES AGENCY OF CALIFORNIA DEPARTMENT OF PARKS AND RECREATION				
CASTLE ROCK STATE PARK PROPOSED NATURAL PRESERVE CLASSIFICATION				
DRAWING NO. 27435.5				
SHEET NO. 6 OF 8				