

**United States Department of the Interior
National Park Service**

**National Register of Historic Places
Registration Form**



This form is for use in nominating or requesting determinations for individual properties and districts. See instructions in National Register Bulletin, *How to Complete the National Register of Historic Places Registration Form*. If any item does not apply to the property being documented, enter "N/A" for "not applicable." For functions, architectural classification, materials, and areas of significance, enter only categories and subcategories from the instructions. **Place additional certification comments, entries, and narrative items on continuation sheets if needed (NPS Form 10-900a).**

1. Name of Property

historic name Wilsonia (Amendment)
 other names/site number Wilsonia Historic District

2. Location

street & number Surrounded by Kings Canyon National Park not for publication
 city or town Wilsonia vicinity
 state California code CA county Tulare code 107 zip code 93633

3. State/Federal Agency Certification

As the designated authority under the National Historic Preservation Act, as amended,
 I hereby certify that this ___ nomination ___ request for determination of eligibility meets the documentation standards for registering properties in the National Register of Historic Places and meets the procedural and professional requirements set forth in 36 CFR Part 60.
 In my opinion, the property ___ meets ___ does not meet the National Register Criteria. I recommend that this property be considered significant at the following level(s) of significance:
 ___ national ___ statewide ___ local

Signature of certifying official/Title _____ Date _____

State or Federal agency/bureau or Tribal Government _____

In my opinion, the property ___ meets ___ does not meet the National Register criteria.

Signature of commenting official _____ Date _____

Title _____ State or Federal agency/bureau or Tribal Government _____

4. National Park Service Certification

I hereby certify that this property is:
 ___ entered in the National Register ___ determined eligible for the National Register
 ___ determined not eligible for the National Register ___ removed from the National Register
 ___ other (explain:) _____

Signature of the Keeper _____ Date of Action _____

5. Classification

Ownership of Property
(Check as many boxes as apply.)

Category of Property
(Check only **one** box.)

Number of Resources within Property*
(Do not include previously listed resources in the count.)

- private
- public - Local
- public - State
- public - Federal

- building(s)
- district
- site
- structure
- object

Contributing	Noncontributing	
162	49	buildings
1	0	site
0	0	structure
0	0	object
163	49	Total

**These numbers wholly supersede those of the 1995 Nomination, and account for revised evaluations, as well as for demolished and newly constructed buildings within the district. For a detailed comparison of 1995 and 2008 evaluations, see the complete listing of resources by address below.*

Name of related multiple property listing
(Enter "N/A" if property is not part of a multiple property listing)

Number of contributing resources previously listed in the National Register

N/A

Contributing	Non-contributing	
139	73	buildings
0	0	sites
0	0	structures
0	0	objects
139	73	Total

6. Function or Use

Historic Functions
(Enter categories from instructions.)

Current Functions
(Enter categories from instructions.)

DOMESTIC/village site

RECREATION/outdoor recreation

LANDSCAPE/forest

DOMESTIC/village site

RECREATION/outdoor recreation

LANDSCAPE/forest

7. Description

Architectural Classification
(Enter categories from instructions.)

Materials
(Enter categories from instructions.)

Late 19th/Early 20th Century American Movements

Other: rustic mountain cabin architecture

foundation: Wood, stone, concrete

walls: Wood

roof: Metal, wood

other: Stone, brick

United States Department of the Interior
National Park Service

National Register of Historic Places
Continuation Sheet

Wilsonia Historic District
Tulare County, CA

Section number 7

Page 3 of 24

7. DESCRIPTION

Summary

On June 14, 1995, a National Register Nomination was completed for the Wilsonia Historic District, a 100-acre village located in the General Grant Grove section of Kings Canyon National Park, in Tulare County, California. At that time, the Historic District was evaluated as being eligible for listing in the National Register of Historic Places under Criterion A at the local level of significance, as a representative recreational mountain community within the broader context of recreational mountain communities developed in California between 1850 and 1950. The period of significance was defined as 1918-1945.

This amendment is intended to update the information contained in the original National Register nomination. Fourteen years have passed since the initial listing of the Wilsonia Historic District. Since that time, some cabins have achieved fifty years of age, others have undergone modifications or been demolished, and new structures have been constructed within the district boundaries. This amendment will extend the period of significance, update evaluations of contributing and non-contributing resources, and add a cultural landscape component.

As outlined in the 1995 National Register Nomination, the Wilsonia Historic District was composed of 212 primary buildings (excluding small guest cabins, sheds, outhouses, and other outbuildings). Of these, 139 (approximately 66%) were evaluated as contributors, and 73 as non-contributors due to age or alterations.

With this amendment, the Wilsonia Historic District now contains a total of 211 primary buildings. Of these, 162 (approximately 77%) are evaluated as contributors, and 49 as non-contributors due to age or alterations. In addition to the individual buildings, the overall cultural landscape is added as a contributing site, for a total of 163 contributing resources within the Wilsonia Historic District.

The resources of the Historic District are described below.

Modifications to Cabins since 1995

Constructed over many decades, the cabins of Wilsonia come in a wide range of shapes and sizes. As the 1995 Nomination acknowledges, most of the cabins in Wilsonia have been altered to varying degrees. In fact, incremental modification is quite characteristic of these simple vernacular structures, many of which began in the 1920s and 1930s as mere platforms for cooking with tents, or as modest one or two-room shelters without plumbing or electricity. Over time, structures may have been enlarged, bathroom and kitchen facilities added in the interiors, and deteriorated roofing and exterior cladding replaced due to the harsh conditions of the natural mountain environment.

Despite these alterations, a majority of the cabins remain modest and simple wooden structures. As was true in 1995, modifications tend to be compatible in design, materials and method of construction, and appear to respect the original builder intent for the structure to blend in with and complement the natural forest setting. With few exceptions, the modifications of the Wilsonia cabins that have occurred since 1995 are consistent with those noted in the 1995 Nomination.

Character-defining features of the cabins include:

- Modest scale, typically one to one and one-half stories in height
- Rectangular or L-shaped plan
- Simple massing with flat exterior facades

United States Department of the Interior
National Park Service

National Register of Historic Places
Continuation Sheet

Wilsonia Historic District
Tulare County, CA

Section number 7

Page 4 of 24

- Medium to high-pitched gables roofs, some with shed roof extensions
- Shingle (wood or composition) or metal roofing
- Wood exterior siding (shingles or shakes, board-and-batten, horizontal board, bark, log)
- Small rectangular windows in wood-frame openings
- Hinged wooden shutters
- Front, side and/or rear porches or decks
- Stone or brick chimneys or metal flues
- Natural landscaping

Typical modifications include the replacement of original wood shingle roofing with composite shingles or metal; replacement wood siding; added, removed, or reconfigured decks and porches; replacement of windows within the original openings; metal flues replacing masonry chimneys; and compatible side or rear additions where the original structure is clearly discernable.

Modifications that have been determined to compromise the integrity of the cabins include alterations that obscure the original structure; partial demolition of the original structure; additions that are out of scale with the original structure; and additions that are indistinguishable from the original structure.

Revised Evaluations of the Cabins

Evaluations that have changed or have been added since the 1995 Wilsonia Historic District Nomination are outlined below. A complete listing of all evaluated properties follows.

Three (3) previous Contributors have been lost to demolition and are no longer extant:

- 83893 Goddard Lane (C-29)
Demolished; this structure was replaced by a new cabin.
- 83786 Hillcrest Road (C-60)
Demolished; this structure was destroyed when a log fell on it.
- 83849 Lilac Lane (C-68)
Demolished; this structure was one of two residences on the property (the second residence is still extant).

One (1) previous Non-contributor that was excluded due to age has been demolished and is no longer extant:

- 83690 Park Road (NC-47)
Demolished; the Old Wilsonia Lodge - along with the 3 motel units on the property - was demolished by the National Park Service. A residential structure remains on the property.

Four (4) previous Contributors have been lost due to alteration, and are now Non-contributors:

- 83763 Hillcrest Road (C-58)
Alterations since 1995 include a large addition; new porch; new deck; and the shingle roof on original structure replaced with metal.

United States Department of the Interior
National Park Service

National Register of Historic Places
Continuation Sheet

Wilsonia Historic District
Tulare County, CA

Section number 7

Page 5 of 24

- 83747 Pine Lane (C-97)
Alterations since 1995 include a new two-story addition that replaced the rear portion of original cabin; new windows in new openings; new balustrade; new shingle siding on top and bottom; new front porch; and a new roof dormer.
- 83656 President's Lane (C-102)
Since 1995, this structure was extensively remodeled or completely reconstructed.
- 83668 Willow Lane (C-133)
Alterations since 1995 include an enclosed front porch; side porch removed; side addition; new enlarged roof; and a new front porch.

Twenty-seven (27) previous Non-contributors that were excluded due to age are now at least 50 years old and have sufficient integrity, and therefore are now evaluated as Contributors:

- 83528 Alta Lane (NC-1)
- 83576 Alta Lane (NC-2)
- 83595 Alta Lane (NC-3)
- 83607 Alta Lane (NC-4)
- 83688 Cedar Lane (NC-7)
- 83730 Cedar Lane (NC-10)
- 83733 Cedar Lane (NC-11)
- 83659 Chinquapin Lane (NC-13)
- 83798 Fern Lane (NC-14)
- 83869 Goddard Lane (NC-15)
- 83631 Grant Lane (NC-16)
- 83644 Hazel Lane (NC-19)
- 83714 Hazel Lane (NC-21)
- 83726 Hazel Lane (NC-22)
- 83808 Laurel Lane (NC-28)
- 83831 Laurel Lane (NC-32)
- 83811 Lily Lane (NC-36)
- 83761 Lupine Lane (NC-37)
- 83696 Manzanita Lane (NC-40)
- 83564 Park Road (NC-44)
- 83735 Park Road (NC-50)
- 83736 Park Road (NC-53)
- 83647 President's Lane (NC-55)
- 83580 Sierra Lane (NC-61)
- 83599 Sierra Lane (NC-63)
- 83658 Willow Lane (NC-70)
- 83728 Willow Lane (NC-73)

Three (3) previous Non-contributors that were excluded due to alterations have been re-evaluated as Contributors:

- 83655 Hazel Lane (NC-20)
There have been no major alterations since 1995. However, the rear addition noted in the 1995 Nomination are compatible and consistent with characteristic modifications of other cabins over time.
- 83777 Meadow Lane (NC-43)
There have been no major alterations since 1995. However, the alterations noted in the 1995 Nomination are compatible and consistent with characteristic modifications of other cabins over time.
- 83672 Willow Lane (NC-71)
There have been no major alterations since 1995. However, the alterations noted in the 1995 Nomination are compatible and consistent with characteristic modifications of other cabins over time.

Two (2) new cabins have been constructed:

- 83899 Goddard Lane
This one and one-half story residence is clad in board-and-batten wood siding. Rectangular in plan, it has flat windows and a pitched metal roof. There is a recessed porch and upper-story balcony on the front

United States Department of the Interior
National Park Service

National Register of Historic Places
Continuation Sheet

Wilsonia Historic District
Tulare County, CA

Section number 7

Page 6 of 24

façade, and a projecting balcony on the rear façade. Constructed some time after 2005, this residence replaced a smaller 1927 cabin (C-29). This structure is a Non-contributor due to age.

- 83751 Pine Lane
This one and one-half story residence is clad in board-and-batten wood siding with wood shingles along the foundation and in the gable end. Rectangular in plan, it has flat windows and a pitched metal roof. There is a deck along the rear façade. Constructed some time after 1995, this residence is one of two on the property; the original cabin also remains. This structure is a Non-contributor due to age.

Architectural Descriptions for New Contributors

As noted above, twenty-seven (27) previous Non-contributors that were excluded due to age are now at least 50 years old and have sufficient integrity, and therefore are now evaluated as Contributors.

83528 Alta Lane (NC-1)

1995 Description This one and one-half story wood frame residence is clad in horizontal wood siding. "L"-shaped in plan, it has flat windows and a pitched roof. Alterations include an addition. The varnished natural wood has been painted brownish red. There is a guest house on the property.

Changes since 1995 No major alterations since 1995.

83576 Alta Lane (NC-2)

1995 Description This one and one-half story residence is clad in wood shingles. "L"-shaped in plan, it has a pitched roof and flat windows. The residence was approximately 800 square feet when purchased by the current owners in 1979. The upstairs, downstairs and porch have since been enlarged. The stairs to the second floor were moved inside and a wood burning stove was added to the living room.

Changes since 1995 Alterations since 1995 include shingle roof replaced with metal; new aluminum window; new wooden shutters.

83595 Alta Lane (NC-3)

1995 Description Rectangular in plan, this one story wood frame residence has a pitched roof and flat windows.

Changes since 1995 Alterations since 1995 include new porch.

83607 Alta Lane (NC-4)

1995 Description Rectangular in plan, this one story wood frame residence has a pitched roof and flat windows.

Changes since 1995 Alterations since 1995 include shingle roof replaced with metal; horizontal wood siding replaced with wood shingle.

United States Department of the Interior
National Park Service

National Register of Historic Places
Continuation Sheet

Wilsonia Historic District
Tulare County, CA

Section number 7

Page 7 of 24

83688 Cedar Lane (NC-7)

1995 Description Rectangular in plan, this one and one half story modified A-frame residence is clad in tongue and groove siding and has casement windows.

Changes since 1995 No major alterations since 1995.

83730 Cedar Lane (NC-10)

1995 Description "L"-shaped in plan, this one and one half story wood frame residence is clad in board and batten siding. It has a pitched shingle roof, flat windows, and a stone chimney.

Changes since 1995 Alterations since 1995 include shingle roof replaced with metal.

83733 Cedar Lane (NC-11)

1995 Description Rectangular in plan, this one and one half story wood frame residence has a pitched aluminum roof and aluminum windows. The original windows were replaced with aluminum sliders in 1972-4. The porch rail has been replaced and the roof was replaced with green sheet metal. An outside staircase was added in 1983.

Changes since 1995 No major alterations since 1995.

83659 Chinquapin Lane (NC-13)

1995 Description Rectangular in plan, this one and one half story cabin has a pitched roof and flat windows.

Changes since 1995 No major alterations since 1995.

83798 Fern Lane (NC-14)

1995 Description Rectangular in plan, this one story cabin has flat windows, a pitched roof, and a brick chimney. It is clad in wood siding which has been painted red. There is an outhouse on the property.

Changes since 1995 Alterations since 1995 include shingle roof replaced with metal.

83869 Goddard Lane (NC-15)

1995 Description This one and one half story residence is clad in board and batten siding. Rectangular in plan, it has flat windows and a pitched metal roof. There is also a contributing residence on the property.

Changes since 1995 No major alterations since 1995. One of two structures on the property.

83631 Grant Lane (NC-16)

1995 Description This one and one half story wood frame residence is clad in horizontal tongue and groove siding. Rectangular in plan, it has flat windows, front and back porches, a brick fireplace, and a pitched roof.

United States Department of the Interior
National Park Service

National Register of Historic Places
Continuation Sheet

Wilsonia Historic District
Tulare County, CA

Section number 7

Page 8 of 24

Changes since 1995 Alterations since 1995 include shingle roof replaced with metal.

83644 Hazel Lane (NC-19)

1995 Description This one story wood frame residence is clad in board and batten siding. Rectangular in plan, it has flat windows and a pitched roof. It is the upper and larger of two cabins on the property.

Changes since 1995 No major alterations since 1995. One of two residences on the property. This is the upper residence.

83714 Hazel Lane (NC-21)

1995 Description This one and one half story residence is clad in horizontal board and batten siding with vertical wood siding at the gable ends. Rectangular in plan, it has a brick chimney, flat windows, and a pitched wood shingle roof.

Changes since 1995 No major alterations since 1995.

83726 Hazel Lane (NC-22)

1995 Description This one and one half story wood frame residence is clad in board and batten siding. Rectangular in plan, it has flat windows and a pitched roof.

Changes since 1995 Alterations since 1995 include roof dormers replaced with skylights; porch reconfigured.

83808 Laurel Lane (NC-28)

1995 Description This one and one half story wood frame residence is clad in a combination of board and batten and angled wood siding. Irregular in plan, it has flat windows and a composition shingle pitched roof.

Changes since 1995 No major alterations since 1995.

83831 Laurel Lane (NC-32)

1995 Description This one and one half story wood frame residence is clad in horizontal wood siding with board and batten siding at the gable ends. Rectangular in plan, it has flat windows and a pitched roof.

Changes since 1995 No major alterations since 1995.

83811 Lily Lane (NC-36)

1995 Description This one and one half story wood frame residence is clad in horizontal tongue and groove siding. Rectangular in plan, it has a pitched shingle roof and flat windows with shutters.

Changes since 1995 No major alterations since 1995.

United States Department of the Interior
National Park Service

National Register of Historic Places
Continuation Sheet

Wilsonia Historic District
Tulare County, CA

Section number 7

Page 9 of 24

83761 Lupine Lane (NC-37)

1995 Description This one and one half story wood frame residence is clad in horizontal tongue and groove siding. Rectangular in plan, it has a pitched roof, flat sash windows, and a prominent front porch.

Changes since 1995 No major alterations since 1995.

83696 Manzanita Lane (NC-40)

1995 Description This one and one half story residence is clad in horizontal wood siding. Rectangular in plan, it has a pitched roof and wood windows.

Changes since 1995 Alterations since 1995 include shingle roof replaced with metal.

83564 Park Road (NC-44)

1995 Description This one and one half story residence is clad in board and batten siding. Rectangular in plan, it has flat windows and a pitched shingle roof.

Changes since 1995 Alterations since 1995 include shingle roof replaced with metal.

83735 Park Road (NC-50)

1995 Description This two story residence is clad in horizontal wood siding. Rectangular in plan, it has flat windows, a brick chimney, and a pitched metal roof.

Changes since 1995 No major alterations since 1995.

83736 Park Road (NC-53)

1995 Description This one and one half story residence is clad in horizontal wood siding. Rectangular in plan, it has flat windows and a pitched roof.

Changes since 1995 Alterations since 1995 include front porch removed by snow. This property is listed in the 1995 nomination as 83739 Pine Lane.

83647 President's Lane (NC-55)

1995 Description This one and one half story residence is clad in wood shingles. Rectangular in plan, it has flat windows and a wood shingle gambrel roof.

Changes since 1995 Alterations since 1995 include new stone foundation; wood shingle roof replaced with composite shingles.

83580 Sierra Lane (NC-61)

1995 Description This one and one half story residence is clad in wood shingles. Rectangular in plan, it has flat windows, a brick chimney, and a pitched metal roof. The deck was replaced in 1990. There is a shed on the property.

United States Department of the Interior
National Park Service

National Register of Historic Places
Continuation Sheet

Wilsonia Historic District
Tulare County, CA

Section number 7

Page 10 of 24

Changes since 1995 No major alterations since 1995.

83599 Sierra Lane (NC-63)

1995 Description This one story residence is clad in horizontal wood siding. Rectangular in plan, it has flat windows and a pitched metal roof. An outhouse and a shed are located on the property.

Changes since 1995 No major alterations since 1995.

83658 Willow Lane (NC-70)

1995 Description Located on the corner of Lilac and Willow Lanes, this one story residence is clad in horizontal wood siding. "L"-shaped in plan, it has flat windows and a pitched shingle roof. An addition was made to the original two room cabin in 1957.

Changes since 1995 Alterations since 1995 include shingle roof replaced with metal.

83728 Willow Lane (NC-73)

1995 Description This one and one half story residence is clad in horizontal overlapping siding with wood shingles at the gable ends. Rectangular in plan, it has flat windows and a pitched metal roof.

Changes since 1995 No major alterations since 1995.

Cultural Landscape

The Wilsonia Historic District is not merely a collection of mountain cabins and associated outbuildings. Instead, it is a geographically-definable *historic vernacular landscape* which has evolved through its use as a recreational mountain community. As such, this landscape contains both natural resources (topography, vegetation and wildlife) and man-made cultural resources (roads, signage, and the cabins themselves).

The 1995 Nomination described many of these elements as character-defining features of the district's overall setting. This amendment identifies these as elements of the *cultural landscape*, which is a contributing site within the Wilsonia Historic District. Features of the cultural landscape include:

- Overall spatial organization
- Natural hilly topography
- Natural vegetation (mixed conifer forest)
- Grassy meadows
- Boulders and rock outcroppings
- Intermittent streams
- Circulation network (over 30 narrow roads, paved and unpaved)
- Wooden post street signage

All of the features listed above contribute to the historic character of the Wilsonia Historic District, and help to convey its significance as a recreational mountain community in California.

United States Department of the Interior
National Park Service

National Register of Historic Places
Continuation Sheet

Wilsonia Historic District
Tulare County, CA

Section number 7

Page 11 of 24

Updated Evaluations

The following is a complete listing of all resources within the Wilsonia Historic District, with previous and current evaluations.

Buildings within the Historic District

Address	1995 Evaluation	Comments	2008 Evaluation
83528 Alta Lane	NC (age)	No major alterations since 1995.	C
83533 Alta Lane	C	Alterations since 1995 include shingle roof replaced with metal.	C
83573 Alta Lane	C	No major alterations since 1995.	C
83576 Alta Lane	NC (age)	Alterations since 1995 include shingle roof replaced with metal; new aluminum window; new wooden shutters.	C
83595 Alta Lane	NC (age)	Alterations since 1995 include new porch.	C
83597 Alta Lane	C	No major alterations since 1995.	C
83607 Alta Lane	NC (age)	Alterations since 1995 include shingle roof replaced with metal; horizontal wood siding replaced with wood shingle.	C
83627 Alta Lane	C	No major alterations since 1995.	C
83637 Alta Lane	C	No major alterations since 1995.	C
83647 Alta Lane	NC (extensive alterations)	No major alterations since 1995.	NC (pre-1995 alterations)
83648 Alta Lane	C	No major alterations since 1995.	C
83614 Brewer Lane	C	No major alterations since 1995.	C
83843 Brewer Lane	NC (age)	No major alterations since 1995.	NC (age)
83682 Cedar Lane	C	No major alterations since 1995.	C
83688 Cedar Lane	NC (age)	No major alterations since 1995.	C
83691 Cedar Lane	--	Lot is vacant, with the exception of a ski rental trailer. Cabin burned down pre-1995.	--
83723 Cedar Lane	C	No major alterations since 1995.	C
83725 Cedar Lane	NC (extensive alterations)	No major alterations since 1995.	NC (pre-1995 alterations)
83727 Cedar Lane	NC (age)	--	NC (age)
83730 Cedar Lane	NC (age)	Alterations since 1995 include shingle roof replaced with metal.	C
83731 Cedar Lane	C	No major alterations since 1995.	C
83733 Cedar Lane	NC (age)	No major alterations since 1995.	C
83637 Chinquapin Lane	NC (age)	No major alterations since 1995.	NC (age)
83649 Chinquapin Lane	--	Lot is vacant. Cabin burned down pre-1995.	--
83659 Chinquapin Lane	NC (age)	No major alterations since 1995.	C

United States Department of the Interior
National Park Service

National Register of Historic Places
Continuation Sheet

Wilsonia Historic District
Tulare County, CA

Section number 7

Page 12 of 24

Address	1995 Evaluation	Comments	2008 Evaluation
83663 Chinquapin Lane	C	No major alterations since 1995.	C
83752 Fern Lane	C	No major alterations since 1995.	C
83762 Fern Lane	C	No major alterations since 1995.	C
83772 Fern Lane	C	Alterations since 1995 include a compatible rear addition.	C
83784 Fern Lane	C	No major alterations since 1995.	C
83792 Fern Lane	C	No major alterations since 1995.	C
83798 Fern Lane	NC (age)	Alterations since 1995 include shingle roof replaced with metal.	C
83801 Fern Lane	C	No major alterations since 1995.	C
83806 Fern Lane	C	No major alterations since 1995.	C
83816 Fern Lane	C	No major alterations since 1995.	C
83830 Fern Lane	C	Alterations since 1995 include shingle roof replaced with metal.	C
83691 Fir Lane	C	No major alterations since 1995. One of two residences on the property.	C
83691 Fir Lane	--	No major alterations since 1995; moved onto the site pre-1995 (exact date unknown). One of two residences on the property; believed to have been built elsewhere and used as an office by the NPS when the maintenance building was being constructed. The 1995 Nomination identifies this structure as a second residence on the property used for storage, and was not evaluated.	NC (moved onto site)
83697 Fir Lane	C	Alterations since 1995 include added or replaced side porch.	C
83707 Fir Lane	C	No major alterations since 1995.	C
83708 Fir Lane	C	No major alterations since 1995. One of two structures on the property.	C
83708 Fir Lane	C	Alterations since 1995 include shingle roof replaced with metal; gable over front entry removed; front porch removed. One of two structures on the property.	C
83869 Goddard Lane	NC (age)	No major alterations since 1995. One of two structures on the property.	C
83869 Goddard Lane	C	No major alterations since 1995. One of two structures on the property.	C
83875 Goddard Lane	C	Alterations since 1995 include porch balustrade removed.	C
83887 Goddard Lane	C	No major alterations since 1995.	C
83893 Goddard Lane	C	Demolished post-1995; replaced by a new cabin post-2005, listed below as 83899 Goddard Lane.	--

United States Department of the Interior
National Park Service

National Register of Historic Places
Continuation Sheet

Wilsonia Historic District
Tulare County, CA

Section number 7Page 13 of 24

Address	1995 Evaluation	Comments	2008 Evaluation
83899 Goddard Lane	C	No major alterations since 1995. One of two structures on the property.	C
83899 Goddard Lane	--	Constructed post-2005; replaced a smaller 1927 cabin (C-29). One of two structures on the property. The owner is currently using an address of 83911 Goddard Lane.	NC (age)
83619 Grant Lane	C	No major alterations since 1995.	C
83620 Grant Lane	C	Alterations since 1995 include shingle roof replaced with metal.	C
83625 Grant Lane	C	Alterations since 1995 include shingle roof replaced with metal.	C
83630 Grant Lane	C	No major alterations since 1995.	C
83631 Grant Lane	NC (age)	Alterations since 1995 include shingle roof replaced with metal.	C
83637 Grant Lane	C	Alterations since 1995 include shingle roof replaced with metal.	C
83650 Grant Lane	C	Alterations since 1995 include steps to front porch reconfigured.	C
83655 Grant Lane	C	Alterations since 1995 include shingle roof replaced with metal.	C
83657 Grant Lane	NC (age)	--	NC (age)
83624 Hazel Lane	C	No major alterations since 1995.	C
83634 Hazel Lane	C	No major alterations since 1995. One of two residences on the property. This is the front residence.	C
83634 Hazel Lane	C	No major alterations since 1995. One of two residences on the property. This is the rear residence.	C
83641 Hazel Lane	NC (extensive alterations)	No major alterations since 1995.	NC (pre-1995 alterations)
83644 Hazel Lane	NC (age)	No major alterations since 1995. One of two residences on the property. This is the upper residence.	C
83644 Hazel Lane	C	No major alterations since 1995. One of two residences on the property. This is the lower residence.	C
83647 Hazel Lane	C	No major alterations since 1995.	C
83651 Hazel Lane	C	No major alterations since 1995.	C
83655 Hazel Lane	NC (large addition)	No major alterations since 1995. Evaluation changed to C; noted pre-1995 alterations are compatible and consistent with alterations to other cabins over time.	C
83687 Hazel Lane	C	Alterations since 1995 include deck removed.	C

United States Department of the Interior
National Park Service

National Register of Historic Places
Continuation Sheet

Wilsonia Historic District
Tulare County, CA

Section number 7Page 14 of 24

Address	1995 Evaluation	Comments	2008 Evaluation
83703 Hazel Lane	C	No major alterations since 1995.	C
83706 Hazel Lane	C	Alterations since 1995 include wood shingle roof has been replaced with new shingles.	C
83709 Hazel Lane	C	No major alterations since 1995.	C
83714 Hazel Lane	NC (age)	No major alterations since 1995.	C
83715 Hazel Lane	C	No major alterations since 1995.	C
83718 Hazel Lane	C	No major alterations since 1995.	C
83723 Hazel Lane	C	No major alterations since 1995.	C
83726 Hazel Lane	NC (age)	Alterations since 1995 include roof dormers replaced with skylights; porch reconfigured.	C
83731 Hazel Lane	NC (large addition)	Alterations since 1995 include shingle roof on front addition replaced with metal.	NC (pre-1995 alterations)
83740 Hazel Lane	C	No major alterations since 1995.	C
83705 Hillcrest Road	C	Alterations since 1995 include front porch enclosed; shingle roof replaced with metal.	C
83706 Hillcrest Road	NC (extensive alterations)	No major alterations since 1995. Note the cabin displays an address of 83874.	NC
83708 Hillcrest Road	C	Alterations since 1995 include shingle roof replaced with metal.	C
83716 Hillcrest Road	C	Alterations since 1995 include shingle roof replaced with metal.	C
83717 Hillcrest Road	C	No major alterations since 1995.	C
83724 Hillcrest Road	C	No major alterations since 1995.	C
83746 Hillcrest Road	NC (age)	No major alterations since 1995. Note the 1995 photo also lists an address of 83777 Fern Lane, which appears to be erroneous.	NC (age)
83754 Hillcrest Road	C	Alterations since 1995 include shingle roof replaced with metal.	C
83763 Hillcrest Road	C	Alterations since 1995 include large addition; new porch; new deck; shingle roof on original structure replaced with metal.	NC (post-1995 alterations)
83775 Hillcrest Road	C	Alterations since 1995 include room addition beneath the porch.	C
83785 Hillcrest Road	NC (extensive alterations)	No major alterations since 1995.	NC (pre-1995 alterations)
83786 Hillcrest Road	C	Demolished post-1995. This cabin was destroyed when a log fell on it; only a shed remains on the property.	--
83793 Hillcrest Road	NC (age)	Alterations since 1995 include roof, foundation, cladding, windows, porch, garage, etc.	NC (age)

United States Department of the Interior
National Park Service

National Register of Historic Places
Continuation Sheet

Wilsonia Historic District
Tulare County, CA

Section number 7Page 15 of 24

Address	1995 Evaluation	Comments	2008 Evaluation
83553 Kaweah Lane	C	Alterations since 1995 include shingle roof replaced with metal.	C
83808 Laurel Lane	NC (age)	No major alterations since 1995.	C
83815 Laurel Lane	C	No major alterations since 1995.	C
83818 Laurel Lane	C	No major alterations since 1995.	C
83819 Laurel Lane	NC (age)	No major alterations since 1995.	NC (age)
83823 Laurel Lane	NC (age)	Alterations since 1995 include shingle roof replaced with metal.	NC (age)
83827 Laurel Lane	NC (age)	No major alterations since 1995.	NC (age)
83831 Laurel Lane	NC (age)	No major alterations since 1995.	C
83831 Le Conte Way	NC (extensive alterations)	No major alterations since 1995.	NC (pre-1995 alterations)
83815 Lilac Lane	C	Alterations since 1995 include new front deck.	C
83825 Lilac Lane	C	No major alterations since 1995.	C
83832 Lilac Lane	C	No major alterations since 1995.	C
83849 Lilac Lane	C	Alterations since 1995 include an addition. Originally one of two residences on the property; the other residence (C-68) has been demolished.	C
83849 Lilac Lane	C	Demolished post-1995. Originally one of two structures on the property; the other residence remains extant.	--
83852 Lilac Lane	NC (age)	No major alterations since 1995.	NC (age)
83855 Lilac Lane	C	No major alterations since 1995.	C
83876 Lilac Lane	C	No major alterations since 1995.	C
83785 Lily Lane	C	No major alterations since 1995.	C
83793 Lily Lane	NC (age)	No major alterations since 1995.	NC (age)
83811 Lily Lane	NC (age)	No major alterations since 1995.	C
83815 Lily Lane	C	No major alterations since 1995.	C
83761 Lupine Lane	NC (age)	No major alterations since 1995.	C
83691 Manzanita Lane	NC (age)	Alterations since 1995 include upper balcony enclosed.	NC (age)
83695 Manzanita Lane	NC (extensive alterations)	No major alterations since 1995.	NC (pre-1995 alterations)
83696 Manzanita Lane	NC (age)	Alterations since 1995 include shingle roof replaced with metal.	C
83699 Manzanita Lane	C	Alterations since 1995 include shingle roof replaced with metal.	C
83716 Manzanita Lane	C	No major alterations since 1995.	C
83722 Manzanita Lane	C	No major alterations since 1995.	C
84747 Manzanita Lane	C	No major alterations since 1995.	C

United States Department of the Interior
National Park Service

National Register of Historic Places
Continuation Sheet

Wilsonia Historic District
Tulare County, CA

Section number 7Page 16 of 24

Address	1995 Evaluation	Comments	2008 Evaluation
83664 Mason Road	C	No major alterations since 1995.	C
83665 Mason Road	NC (age)	No major alterations since 1995.	NC (age)
83674 Mason Road	C	Alterations since 1995 include portion of shingle roof replaced by metal.	C
83677 Mason Road	C	Alterations since 1995 include shingle roof replaced with metal.	C
83686 Mason Road	C	No major alterations since 1995.	C
83689 Mason Road	C	Alterations since 1995 include shingle roof replaced with metal.	C
83696 Mason Road	C	No major alterations since 1995.	C
83699 Mason Road	NC (additions)	No major alterations since 1995.	NC (pre-1995 alterations)
83706 Mason Road	C	No major alterations since 1995.	C
83777 Meadow Lane	NC (extensive alterations)	No major alterations since 1995. Evaluation changed to C; noted pre-1995 alterations are compatible and consistent with alterations to other cabins over time.	C
83521 Palisades Way	C	Alterations since 1995 include shingle roof replaced with metal. This cabin was listed in the 1995 NR nomination as being a second residential structure at 83552 Sierra Lane, which appears to be erroneous.	C
83550 Park Road	C	Alterations since 1995 include shingle roof replaced with metal.	C
83564 Park Road	NC (age)	Alterations since 1995 include shingle roof replaced with metal.	C
83572 Park Road	C	No major alterations since 1995.	C
83578 Park Road	C	Alterations since 1995 include shingle roof replaced with metal. Note that the design of this residence is inconsistent with the other cabins (two full stories, hip roof). However, it is believed that it retains its original appearance.	C
83582 Park Road	C	Alterations since 1995 include front door replaced; windows replaced; shutters removed; front porch replaced; masonry chimney replaced with metal; attached shed replaced.	C
83588 Park Road	C	Alterations since 1995 include shingle roof replaced with metal.	C
83622 Park Road	NC (age)	This cabin appears incompatible and inconsistent with others in scale, materials, plan, etc. It may have has several alterations and/or additions.	NC (incompatible design; possible alterations pre-1995)
83643 Park Road	NC (age)	No major alterations since 1995.	NC (age)

United States Department of the Interior
National Park Service

National Register of Historic Places
Continuation Sheet

Wilsonia Historic District
Tulare County, CA

Section number 7

Page 17 of 24

Address	1995 Evaluation	Comments	2008 Evaluation
83653 Park Road	C	Alterations since 1995 include side addition reconfigured; shingle roof on side addition replaced with metal.	C
83662 Park Road	C	No major alterations since 1995.	C
83690 Park Road	NC (age)	Demolished post-1995. The Old Wilsonia Lodge - along with the 3 detached motel units on the property - were demolished by NPS. A residence (C-91) remains on the property.	--
83690 Park Road	C	No major alterations since 1995. This residence is the only structure remaining on the property; it was moved to Cedar Lane but retains its Park Road address. The Old Wilsonia Lodge and 3 motel units were demolished by NPS post-1995.	C
83696 Park Road	NC (extensive alterations)	No major alterations since 1995. This property was listed in the 1995 NR Nominaton as 83693, which appears to be erroneous.	NC (pre-1995 alterations)
83723 Park Road	C	No major alterations since 1995.	C
83727 Park Road	NC (alterations)	Alterations since 1995 include rear addition; new roof dormer.	NC (pre- and post-1995 alterations)
83735 Park Road	NC (age)	No major alterations since 1995.	C
83736 Park Road	NC (age)	Alterations since 1995 include front porch removed by snow. This property is listed in the 1995 nomination as 83739 Pine Lane.	C
83740 Park Road	C	No major alterations since 1995.	C
83748 Park Road	C	No major alterations since 1995. One of two residences on the property; each has its own address.	C
83750 Park Road	C	No major alterations since 1995. One of two residences on the property; each has its own address.	C
83725 Pine Lane	C	Alterations since 1995 include metal shed roof added over a portion of the porch.	C
83728 Pine Lane	NC (age)	Alterations since 1995 include wood cladding on lower portion of cabin and porch replaced; shingle roof replaced with metal. This residence replaced the original cabin destroyed by fire.	NC (age)
83732 Pine Lane	NC (age)	Alterations since 1995 include second story addition; shingle roof replaced with metal. This cabin was substantially altered or completely rebuilt post-1995.	NC (age)

United States Department of the Interior
National Park Service

National Register of Historic Places
Continuation Sheet

Wilsonia Historic District
Tulare County, CA

Section number 7Page 18 of 24

Address	1995 Evaluation	Comments	2008 Evaluation
83747 Pine Lane	C	Alterations since 1995 include new two-story addition replaced rear portion of original cabin; new windows in new openings; new balustrade; new shingle siding on top and bottom; new front porch; new roof dormer.	NC (post-1995 alterations)
83751 Pine Lane	--	Constructed post-1995. One of two residences on the property; the original cabin remains extant.	NC (age)
83755 Pine Lane	C	No major alterations since 1995. One of two residences on the property.	C
83629 President's Lane	C	Alterations since 1995 include shingle roof replaced with metal.	C
83634 President's Lane	C	Alterations since 1995 include shingle roof replaced with metal; woodlap siding replaced with wood paneling.	C
83643 President's Lane	NC (age)	Alterations since 1995 include shingle roof replaced with metal.	NC (age)
83647 President's Lane	NC (age)	Alterations since 1995 include new stone foundation; wood shingle roof replaced with composite shingles.	C
83648 President's Lane	C	No major alterations since 1995.	C
83656 President's Lane	C	Cabin extensively remodeled or completely reconstructed post-1995.	NC (post-1995 alterations)
83661 President's Lane	C	Alterations since 1995 include tree bark siding on side elevation replaced with wood shingles.	C
83666 President's Lane	C	Alterations since 1995 include area of board-and-batten siding replaced with wood shingles.	C
83667 President's Lane	C	Alterations since 1995 include new porch.	C
83673 President's Lane	NC (age)	No major alterations since 1995. Note that this cabin is listed in the 1995 Nomination as 83671; this address also appears on the cabin itself in the 2007 photo.	NC (age)
83672 President's Lane	C	No major alterations since 1995.	C
83677 President's Lane	C	No major alterations since 1995.	C
83681 President's Lane	C	No major alterations since 1995.	C
83688 President's Lane	C	Alterations since 1995 include porch enclosed.	C
83732 President's Lane	C	No major alterations since 1995.	C
83740 President's Lane	NC (age)	No major alterations since 1995.	NC (age)
83552 Sierra Lane	C	Alterations since 1995 include shingle roof replaced with metal. The 1995 Nomination identified a second residence (C-112) at this address, which is actually located at 83521 Palisades Way.	C
83559 Sierra Lane	C	Alterations since 1995 include shingle roof replaced with metal.	C

United States Department of the Interior
National Park Service

National Register of Historic Places
Continuation Sheet

Wilsonia Historic District
Tulare County, CA

Section number 7Page 19 of 24

Address	1995 Evaluation	Comments	2008 Evaluation
83565 Sierra Lane	NC (age)	Alterations since 1995 include shingle roof replaced with metal.	NC (age)
83571 Sierra Lane	NC (age)	No major alterations since 1995.	NC (age)
83577 Sierra Lane	NC (age)	Alterations since 1995 include shingle roof replaced with metal.	NC (age)
83580 Sierra Lane	NC (age)	No major alterations since 1995.	C
83587 Sierra Lane	NC (age)	No major alterations since 1995.	NC (age)
83599 Sierra Lane	NC (age)	No major alterations since 1995.	C
83615 Sierra Lane	C	No major alterations since 1995.	C
83618 Sierra Lane	C	No major alterations since 1995.	C
83621 Sierra Lane	C	Alterations since 1995 include shingle roof replaced with metal.	C
83628 Sierra Lane	NC (extensive alterations)	Alterations since 1995 include shingle roof replaced with metal.	NC (pre-1995 alterations)
83638 Sierra Lane	C	Alterations since 1995 include shingle roof replaced with metal.	C
83648 Sierra Lane	C	Alterations since 1995 include shingle roof replaced with metal.	C
83829 Sierra Lane	C	No major alterations since 1995.	C
83841 Sierra Lane	C	Alterations since 1995 include shingle roof replaced with metal.	C
83849 Sierra Lane	C	No major alterations since 1995.	C
83855 Sierra Lane	C	Alterations since 1995 include shingle roof replaced with metal.	C
83858 Sierra Lane	C	No major alterations since 1995.	C
83865 Sierra Lane	C	No major alterations since 1995.	C
83845 Tehipite Way	C	No major alterations since 1995.	C
83885 Tyndall Lane	C	Alterations since 1995 include shingle roof replaced with metal. Property is listed as 83855 Tyndall Lane in the 1995 Nomination, which appears to be erroneous.	C
83888 Tyndall Lane	C	No major alterations since 1995.	C
83894 Tyndall Lane	C	No major alterations since 1995.	C
83855 Whitney Lane	NC (age)	No major alterations since 1995.	NC (age)
83866 Whitney Lane	NC (multiple additions)	Alterations since 1995 include shingle roof replaced with metal; wood windows replaced with aluminum.	NC (pre-1995 alterations)
83867 Whitney Lane	--	Lot is vacant. Cabin demolished pre-1995.	--
83873 Whitney Lane	C	Alterations since 1995 include shingles added around entry.	C
83880 Whitney Lane	NC (age)	No major alterations since 1995.	NC (age)

United States Department of the Interior
National Park Service

National Register of Historic Places
Continuation Sheet

Wilsonia Historic District
Tulare County, CA

Section number 7

Page 20 of 24

Address	1995 Evaluation	Comments	2008 Evaluation
83624 Willow Lane	C	Alterations since 1995 include new storage shed; altered porch balustrade.	C
83633 Willow Lane	C	No major alterations since 1995.	C
83638 Willow Lane	NC (alteration)	No major alterations since 1995.	NC (pre-1995 alterations)
83649 Willow Lane	NC (age)	No major alterations since 1995.	NC (age)
83658 Willow Lane	NC (age)	Alterations since 1995 include shingle roof replaced with metal.	C
83664 Willow Lane	C	No major alterations since 1995.	C
83668 Willow Lane	C	Alterations since 1995 include enclosed front porch; side porch removed; side addition; new enlarged roof; new front porch.	NC (post-1995 alterations)
83669 Willow Lane	C	No major alterations since 1995.	C
83672 Willow Lane	NC (alteration)	No major alterations since 1995. Evaluation changed to C; noted pre-1995 alterations are compatible and consistent with alterations to other cabins over time.	C
83673 Willow Lane	C	No major alterations since 1995.	C
83679 Willow Lane	C	No major alterations since 1995.	C
83686 Willow Lane	C	No major alterations since 1995.	C
83698 Willow Lane	C	No major alterations since 1995.	C
83710 Willow Lane	C	No major alterations since 1995.	C
83720 Willow Lane	NC (alterations)	No major alterations since 1995.	NC (pre-1995 alterations)
83728 Willow Lane	NC (age)	No major alterations since 1995.	C

Site within the Historic District

Description	1995 Evaluation	Comments	2008 Evaluation
Cultural Landscape	(none)	The cultural landscape is a site within the district.	C
(Meadow)	--	Feature of the cultural landscape.	--
(Meadow)	--	Feature of the cultural landscape.	--
(Meadow)	--	Feature of the cultural landscape.	--
(Meadow)	--	Feature of the cultural landscape.	--
(Road)	--	Feature of the cultural landscape.	--
(Road)	--	Feature of the cultural landscape.	--
(Road)	--	Feature of the cultural landscape.	--
(Rock outcroppings)	--	Feature of the cultural landscape.	--
(Rock outcroppings)	--	Feature of the cultural landscape.	--

United States Department of the Interior
National Park Service

National Register of Historic Places
Continuation Sheet

Wilsonia Historic District
Tulare County, CA

Section number 7

Page 21 of 24

Description	1995 Evaluation	Comments	2008 Evaluation
(Rock outcroppings)	--	Feature of the cultural landscape.	--
(Signage)	--	Feature of the cultural landscape.	--
(Signage)	--	Feature of the cultural landscape.	--
(Signage)	--	Feature of the cultural landscape.	--
(Signage)	--	Feature of the cultural landscape.	--

United States Department of the Interior
National Park Service

National Register of Historic Places Continuation Sheet

Wilsonia Historic District
Tulare County, CA

Section number 8

Page 22 of 24

8. STATEMENT OF SIGNIFICANCE

Wilsonia as a Cultural Landscape

The following discussion of the Wilsonia Historic District as a cultural landscape is intended to augment the existing significance statement outlined in the original 1995 National Register Nomination.

The National Park Service recognizes a site as a type of resource that can contribute to the significance of a historic district. A **site** is defined as "the location of a significant event, a prehistoric or historic occupation or activity, or a building or structure, whether standing, ruined or vanished, where the location itself possesses historic, cultural, or archaeological value regardless of the value of any existing structure." The concept of a cultural landscape is helpful in further understanding and assessing historic sites.

The National Park Service defines a **cultural landscape** as "a geographic area...associated with an historic event, activity, or person or exhibiting other cultural or aesthetic values." One of the four types of cultural landscapes is a **historic vernacular landscape**, defined as a "landscape that evolved through use by the people whose activities or occupancy shaped that landscape...Function plays a significant role in vernacular landscapes."

There are five defining features of a cultural landscape: topography, vegetation, circulation, water features and structures (including furnishings and objects). According to National Park Service Guidelines, "it is the arrangement and the interrelationship of these character-defining features as they existed during the period of significance that is most critical..." As such, spatial organization and land patterns are of primary concern when defining and evaluating a cultural landscape.

Using this framework, Wilsonia is a significant **cultural landscape**, which is a contributing site within the Wilsonia Historic District. It is a geographically-definable area characterized by its use as a recreational mountain community in California, and its evolution over time reflects the activities of its occupants. It is a landscape composed of both natural resources (topography, vegetation and wildlife) and man-made cultural resources (roadways, signage, and the cabins themselves).

As outlined in the original 1995 National Register nomination, the Wilsonia Historic District exemplifies the intersection of two important national trends associated with the development of mountain resorts, cabins and summer homes in California's Sierra Nevada in the early to mid-20th century. These national trends which converge during this period are the outdoor recreation movement and the proliferation of the automobile.

Wilsonia was established at the height of the outdoor recreation movement in the United States which promoted the use and adaptation of the nation's forests for recreational purposes. This movement contributed to an increased public awareness and appreciation of California's unique natural environment. It coincided with the improved mobility offered by increasing rates of automobile ownership and the establishment of the State highway system. Some of the nation's first highways linked metropolitan areas to popular mountain resorts and summer recreation areas. These roads continued to be constructed and improved in the first few decades of the 20th century, thus providing greater access to mountain areas by the general populous for recreational purposes. As a result of these trends, California saw a dramatic rise in the development of mountain recreational communities during this period.

The influence of these trends is evident in the manner in which the landscape of Wilsonia has evolved over time, from a natural forest environment to a recreational landscape of both natural and compatible man-made features. From its inception, the property owners of Wilsonia had a concern for conservation and protection of the forest landscape. When the area was first subdivided, roads were laid to follow the natural contours of the land, while grassy meadows and trees measuring over six inches in diameter were preserved. The cabins themselves were constructed of native materials such as wood and stone in order to complement the rustic natural setting. Similarly,

United States Department of the Interior
National Park Service

National Register of Historic Places
Continuation Sheet

Wilsonia Historic District
Tulare County, CA

Section number 8

Page 23 of 24

the siting and orientation of the structures was often determined by the natural features of the property, such as slopes, trees and rock outcroppings.

Today, the site continues to reflect the outdoor focus of life in Wilsonia, as well as an ongoing respect and appreciation for its natural forest setting. The overall character and spatial organization of the landscape remains highly intact, including the original circulation network and the preservation of the site's hilly topography, grassy meadows, boulders and rock outcroppings, and forest vegetation. The landscape retains a strong sense of place from the period of significance.

Period of Significance

The 1995 Nomination defined the period of significance as 1918-1945. With this amendment, the period of significance is extended to 1959, in order to include additional cabins that have now achieved 50 years of age. Beginning in the 1960s, more contemporary designs were introduced, including the A-frame. Also during this period, the National Park Service intensified its purchase of property in Wilsonia, either converting cabins to staff use or demolishing structures and leaving vacant lots. In more recent decades, Wilsonia has primarily seen the remodeling of existing cabins and very limited new development.

Conclusion

The original 1995 National Register Nomination characterizes Wilsonia as a "cultural feature on the forest landscape." Its unique combination of built and natural elements makes the Wilsonia Historic District a significant vernacular cultural landscape in California. The Wilsonia Historic District remains eligible for listing in the National Register of Historic Places under Criterion A at the local level of significance, as representative of recreational mountain communities developed in California between 1850 and 1950.

United States Department of the Interior
National Park Service

National Register of Historic Places
Continuation Sheet

Wilsonia Historic District
Tulare County, CA

Section number 8; 11

Page 24 of 24

11. FORM PREPARED BY

Name/Title Kari Michele Fowler, Senior Preservation Planner Organization Historic Resources Group

Address 1728 N. Whitley Avenue, Los Angeles CA 90028 Telephone (323) 469-2349

Date April 20, 2010

ADDITIONAL DOCUMENTATION

Photography

- Digital photos of new contributors to the district and representative photos of the cultural landscape.
- 4"x6" color prints of new contributors to the district and representative photos of the cultural landscape.
- Photo log for new contributors to the district and representative photos of the cultural landscape.

Photographs were taken between October 2007 and August 2008.

Property Owner Information

- Property owner contact information and APNs for all resources within the district.

Maps

- Sketch map indicating the district boundary, as well as contributors whose status has not changed, contributors that were previously non-contributors, and non-contributors that were previously contributors.
- Photo key map of new contributors to the district.

1995 National Register Nomination

- A copy of the original National Register Nomination was previously submitted for reference.

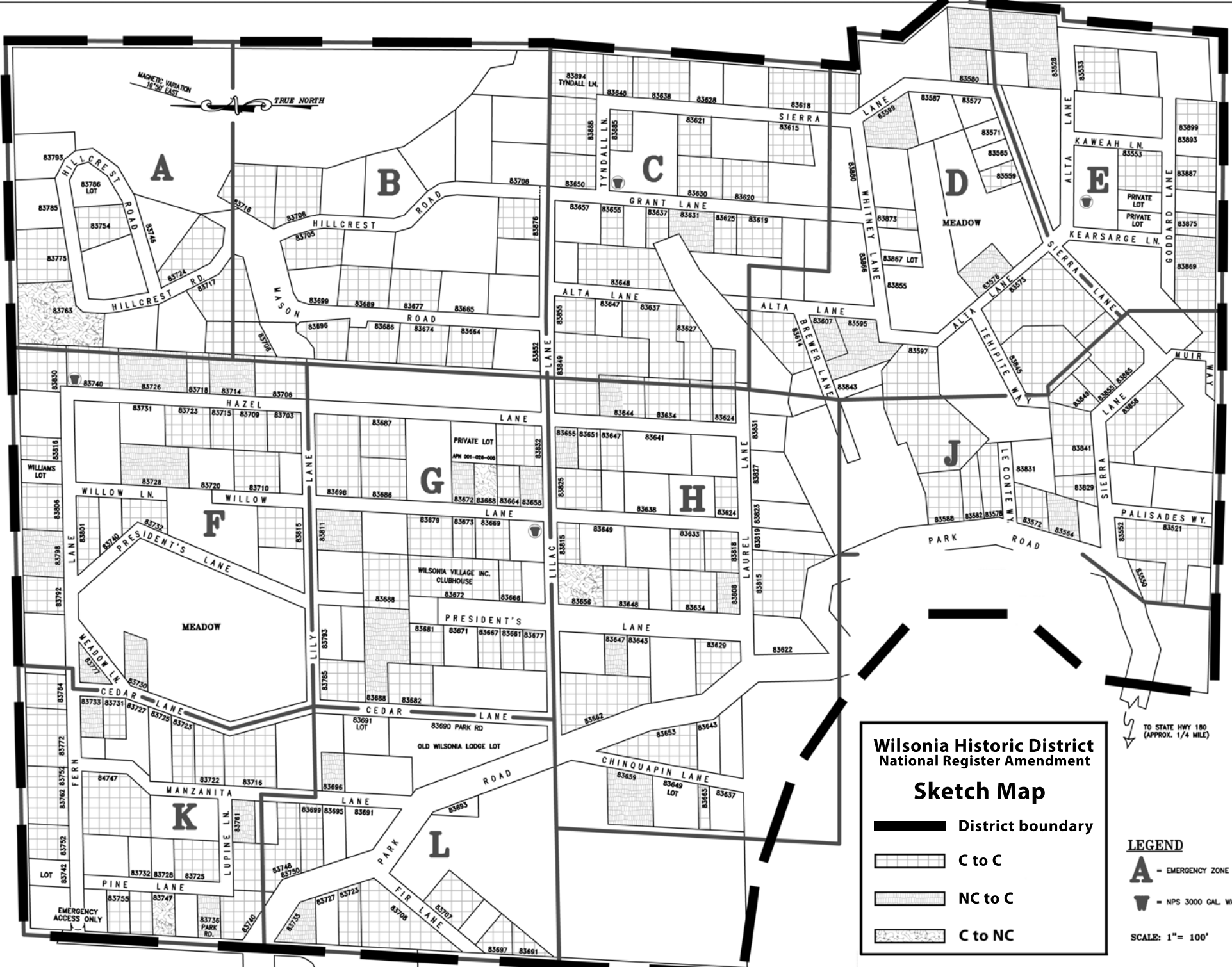

MAGNETIC VARIATION
16°50' EAST
TRUE NORTH

**Wilsonia Historic District
National Register Amendment**

Sketch Map

- District boundary
- C to C
- NC to C
- C to NC

LEGEND

- A** = EMERGENCY ZONE DESIGNATION
- = NPS 3000 GAL. WATER TANK

SCALE: 1" = 100'

TO STATE HWY 180
(APPROX. 1/4 MILE)

N.P.S. - GRANT GROVE
FIRE STATION &
MAINTENANCE YARD

A MAP OF
WILSONIA
LOCATED IN
KINGS CANYON NATIONAL PARK

TO STATE HWY 180
(APPROX. 1/4 MILE)