

United States Department of the Interior  
National Park Service

# National Register of Historic Places Registration Form

This form is for use in nominating or requesting determinations for individual properties and districts. See instructions in National Register Bulletin, *How to Complete the National Register of Historic Places Registration Form*. If any item does not apply to the property being documented, enter "N/A" for "not applicable." For functions, architectural classification, materials, and areas of significance, enter only categories and subcategories from the instructions. **Place additional certification comments, entries, and narrative items on continuation sheets if needed (NPS Form 10-900a).**

## 1. Name of Property

historic name Frank, Richard & Mary Alice Garden

**DRAFT**

other names/site number \_\_\_\_\_

## 2. Location

street & number 919 La Loma Road

not for publication

city or town Pasadena

vicinity

state California code CA county Los Angeles code 37 zip code 91105

## 3. State/Federal Agency Certification

As the designated authority under the National Historic Preservation Act, as amended,

I hereby certify that this \_\_\_ nomination \_\_\_ request for determination of eligibility meets the documentation standards for registering properties in the National Register of Historic Places and meets the procedural and professional requirements set forth in 36 CFR Part 60.

In my opinion, the property \_\_\_ meets \_\_\_ does not meet the National Register Criteria. I recommend that this property be considered significant at the following level(s) of significance:

\_\_\_ national    \_\_\_ statewide    \_\_\_ local

Signature of certifying official/Title \_\_\_\_\_

Date \_\_\_\_\_

State or Federal agency/bureau or Tribal Government \_\_\_\_\_

In my opinion, the property \_\_\_ meets \_\_\_ does not meet the National Register criteria.

Signature of commenting official \_\_\_\_\_

Date \_\_\_\_\_

Title \_\_\_\_\_

State or Federal agency/bureau or Tribal Government \_\_\_\_\_

## 4. National Park Service Certification

I hereby certify that this property is:

\_\_\_ entered in the National Register

\_\_\_ determined eligible for the National Register

\_\_\_ determined not eligible for the National Register

\_\_\_ removed from the National Register

\_\_\_ other (explain:) \_\_\_\_\_

Signature of the Keeper \_\_\_\_\_

Date of Action \_\_\_\_\_

Richard & Mary Alice Frank Garden  
Name of Property

Los Angeles County, CA  
County and State

**5. Classification**

**Ownership of Property**  
(Check as many boxes as apply.)

**Category of Property**  
(Check only **one** box.)

**Number of Resources within Property**  
(Do not include previously listed resources in the count.)

- private
- public - Local
- public - State
- public - Federal

- building(s)
- district
- site
- structure
- object

Contributing	Noncontributing	
	1	buildings
1		sites
2		structures
		objects
3	1	<b>Total</b>

**Name of related multiple property listing**  
(Enter "N/A" if property is not part of a multiple property listing)

**Number of contributing resources previously listed in the National Register**

Historic Designed Gardens in Pasadena

0

**6. Function or Use**

**Historic Functions**  
(Enter categories from instructions.)

**Current Functions**  
(Enter categories from instructions.)

LANDSCAPE/Garden

LANDSCAPE/Garden

**7. Description**

**Architectural Classification**  
(Enter categories from instructions.)

**Materials**  
(Enter categories from instructions.)

N/A

foundation: N/A

walls: N/A

roof: N/A

other:

Richard & Mary Alice Frank Garden  
Name of Property

Los Angeles County, CA  
County and State

---

### **Narrative Description**

(Describe the historic and current physical appearance of the property. Explain contributing and noncontributing resources if necessary. Begin with a **summary paragraph** that briefly describes the general characteristics of the property, such as its location, setting, size, and significant features.)

#### **Summary Paragraph**

The Richard & Mary Alice Frank Garden is a private residential designed garden built in 1957 to a design by Garrett Eckbo. It is located on La Loma Road in the southwestern portion of the City of Pasadena. The property is within a hilly, large-lot single-family residential neighborhood and is 0.88 acre in size. The garden wraps around the entire house and is divided by a curving driveway. It has three distinct components: an entry garden west of the house, a pool area east of the house, and the connecting space between these components to the north. The garden includes interlocking rectangular pathways in brick and pebble pavement, wood pergolas extending from the house, slatted wood benches (both freestanding and wall-mounted) landscape beds and planters with native plantings (grasses, cacti and flowering shrubs) and boulders and two small lawn areas. The swimming pool east of the house has two interlocking rectangular components surrounded by a concrete deck. The house on the property is non-contributing to this nomination of the garden and was listed in the National Register of Historic Places in 2008.

---

### **Narrative Description**

The Richard & Mary Alice Frank Garden is a private residential designed garden built in 1957 to a design by Garrett Eckbo. It is located on the north side of La Loma Road, a curving east-west-oriented street in the southwestern portion of the City of Pasadena, between Hillside Terrace and South San Rafael Avenue. The property is within a hilly single-family residential neighborhood of large lots, most of which are over one acre in size. The house is roughly in the center of the lot with the gardens wrapping around the west, north and east sides. The south side has a concrete driveway flanked by natural hillside.

The site slopes dramatically down from west to east and north to south. The garden on the east side of the house extends from the driveway to the main entry of the house and includes an area of lawn at the southern end, adjacent to the driveway, with a gradually stepping pathway of interlocking rectangular panels of pebble pavement framed in wood. West of the pathway is a planting bed and brick retaining wall with an attached slatted-wood bench. The pathway leads to a set of wide, wood-framed brick steps leading to an upper terrace adjacent to the house and paved in the same wood-framed pebble pavement as the lower pathway. The entry garden, which has a Japanese influenced design, is more formal in character and includes a wood pergola that extends from the house to a three-sided brick retaining wall opposite the house. Between the pathway and the retaining wall is a planting bed with short grasses, boulders, a single tree extending above the pergola and a rectangular wood-framed raised planter filled with stones and oriented perpendicular to the house.

A set of boulder steps that transition to brick provides access to a decomposed granite path that extends behind the formal entry garden to the north side of the house. The northern portion of the garden has a more naturalistic character that provides a transition from the entry garden on the west to a patio and pool east of the house. A wood-framed brick pathway gradually steps down from the patio to the pool area. The pool is a large rectangle with an interlocking small rectangle extending from the pool to form the steps. The pool is surrounded by a wide concrete pad with brick retaining walls on the north and west sides that creates a planting area between the pool deck and the house. A slatted-wood bench is attached to the wall at the corner. Also attached to the wall is a wooden storage box, the face of which has a relief carving of a snail on a branch. A set of wide steps constructed of wood-framed pebble paving provides access from the back door of the house to the pool deck. Another set of steps, flanked by planters, descends from the pool deck to a lawn area with a curving edge. A concrete pathway and steps extends from the southwest corner of the lawn area to provide access to the driveway and attached garage.

The Frank House, designed by master architects Buff, Straub & Hensman, is non-contributing to this nomination of the garden and was listed in the National Register of Historic Places in 2008.

Richard & Mary Alice Frank Garden  
Name of Property

Los Angeles County, CA  
County and State

**8. Statement of Significance**

**Applicable National Register Criteria**

(Mark "x" in one or more boxes for the criteria qualifying the property for National Register listing.)

- A Property is associated with events that have made a significant contribution to the broad patterns of our history.
- B Property is associated with the lives of persons significant in our past.
- C Property embodies the distinctive characteristics of a type, period, or method of construction or represents the work of a master, or possesses high artistic values, or represents a significant and distinguishable entity whose components lack individual distinction.
- D Property has yielded, or is likely to yield, information important in prehistory or history.

**Areas of Significance**

(Enter categories from instructions.)

Landscape architecture  
\_\_\_\_\_  
\_\_\_\_\_  
\_\_\_\_\_

**Period of Significance**

1957  
\_\_\_\_\_

**Significant Dates**

1957  
\_\_\_\_\_  
\_\_\_\_\_

**Significant Person**

(Complete only if Criterion B is marked above.)

N/A  
\_\_\_\_\_

**Cultural Affiliation**

N/A  
\_\_\_\_\_

**Architect/Builder**

Garrett Eckbo  
\_\_\_\_\_  
\_\_\_\_\_

**Criteria Considerations**

(Mark "x" in all the boxes that apply.)

Property is:

- A Owned by a religious institution or used for religious purposes.
- B removed from its original location.
- C a birthplace or grave.
- D a cemetery.
- E a reconstructed building, object, or structure.
- F a commemorative property.
- G less than 50 years old or achieving significance within the past 50 years.

**Period of Significance (justification)**

The garden was constructed in 1957 and only minor changes have occurred to it since that time.

**Criteria Considerations (explanation, if necessary)**

N/A

Richard & Mary Alice Frank Garden  
Name of Property

Los Angeles County, CA  
County and State

**Statement of Significance Summary Paragraph** (Provide a summary paragraph that includes level of significance and applicable criteria.)

Built in 1957, the Richard & Mary Alice Frank garden is a locally significant example of the "California Modern Residential" property type under the context "Residential Garden Design in Pasadena: 1945-1968" documented in the Multiple Property Documentation Form "Historic Designed Gardens in Pasadena." It is also an example of the work of master landscape architect Garrett Eckbo. It meets National Register criterion C by embodying the distinctive characteristics of the property type and meets registration requirements listed in the Multiple Property Documentation Form.

**Narrative Statement of Significance** (Provide at least **one** paragraph for each area of significance.)

The Richard & Mary Alice Frank Garden is locally significant under Criterion C. Under this criterion, the garden is a notable example of a designed residential garden of the California Modern Residential property type and the work of master landscape architect Garrett Eckbo. The garden exhibits the defining characteristics of the property type including horizontal focus; interlocking geometric planes; clearly delineated circulation patterns; outdoor rooms; linkages between the architecture and the landscape; terraces and grade changes; scenic views and vistas; low walls and integrated planters, brick, concrete and pebble paving laid in decorative patterns; a swimming pool; naturalistic and distinctive plantings; Japanese-inspired design principles and association with a Mid-Century Modern building. The garden retains integrity through its location, design, setting, materials, workmanship and feeling and continues to retain essential character-defining features and distinctive characteristics of its period and method of construction. Very little change has been made to the garden since its original construction and it clearly exhibits evidence of techniques employed in residential garden design in the 1950's and 1960's in Pasadena and clearly expresses the historic sense of this time period.

**Developmental history/additional historic context information** (if appropriate)

N/A – Historic context documented in Multiple Property Documentation Form "Historic Designed Gardens in Pasadena."

**9. Major Bibliographical References**

**Bibliography** (Cite the books, articles, and other sources used in preparing this form.)

Permit research materials, assessor's records and historic designation reports in files, Planning Department, City of Pasadena (referenced in August 2012).

Environmental Design Archives, University of California at Berkeley, Garrett Eckbo Collection ([www.ced.berkeley.edu/cedarchives/index.html](http://www.ced.berkeley.edu/cedarchives/index.html) - referenced in October 2011)

**Previous documentation on file (NPS):**

preliminary determination of individual listing (36 CFR 67 has been requested)  
 previously listed in the National Register  
 previously determined eligible by the National Register  
 designated a National Historic Landmark  
 recorded by Historic American Buildings Survey # \_\_\_\_\_  
 recorded by Historic American Engineering Record # \_\_\_\_\_  
 recorded by Historic American Landscape Survey # \_\_\_\_\_

**Primary location of additional data:**

State Historic Preservation Office  
 Other State agency  
 Federal agency  
 Local government  
 University  
 Other  
Name of repository: \_\_\_\_\_

Historic Resources Survey Number (if assigned):

N/A

Richard & Mary Alice Frank Garden  
Name of Property

Los Angeles County, CA  
County and State

---

## 10. Geographical Data

---

**Acreage of Property** 0.90  
(Do not include previously listed resource acreage.)

### UTM References

(Place additional UTM references on a continuation sheet.)

1 \_\_\_\_\_  
Zone Easting Northing

3 \_\_\_\_\_  
Zone Easting Northing

2 \_\_\_\_\_  
Zone Easting Northing

4 \_\_\_\_\_  
Zone Easting Northing

### Verbal Boundary Description (Describe the boundaries of the property.)

The property is bound by La Loma Road on the south and the boundaries of 919 La Loma Road on the west, north and east. The Los Angeles County Assessor's Parcel number for the property is 5714-033-012.

### Boundary Justification (Explain why the boundaries were selected.)

The boundaries were selected because they encompass the extent of features associated with the Richard & Mary Alice Frank Garden.

---

## 11. Form Prepared By

---

name/title Kevin Johnson/Planner

organization City of Pasadena

date August 28, 2012

street & number 175 N. Garfield Avenue

telephone (626) 744-7806

city or town Pasadena

state CA

zip code 91101

e-mail kevinjohnson@cityofpasadena.net

---

## Additional Documentation

---

Submit the following items with the completed form:

- **Maps:** A **USGS map** (7.5 or 15 minute series) indicating the property's location.

A **Sketch map** for historic districts and properties having large acreage or numerous resources. Key all photographs to this map.

- **Continuation Sheets**
- **Additional items:** (Check with the SHPO or FPO for any additional items.)

Richard & Mary Alice Frank Garden  
Name of Property

Los Angeles County, CA  
County and State

---

**Photographs:**

Submit clear and descriptive photographs. The size of each image must be 1600x1200 pixels at 300 ppi (pixels per inch) or larger. Key all photographs to the sketch map.

The following is the same for all photographs:

Name of Property: Richard & Mary Alice Frank Garden  
City: Pasadena  
County: Los Angeles  
State: California  
Name of Photographer: Kevin Johnson  
Date Photographed: May 18, 2012  
Location of Original Digital Files: 175 N. Garfield Avenue, Pasadena, CA 91101

Description of Photograph(s) and number:

1. West garden area - Looking north from driveway
2. West garden area - Looking northwest from driveway
3. West garden area - Looking north from north end of lawn
4. Entry garden - Looking northwest from north end of stepped path
5. Entry garden - Looking southwest from house entry
6. Planter detail – Looking west from house entry
7. Path detail – Looking north from top of slope west of entry garden
8. Rear patio – Looking west from west end of pool pathway
9. Pool pathway – Looking west from east end of pathway
10. Pool deck – Looking northeast from southwest corner of pool deck
11. Rear entry steps – Looking west from southwest corner of pool deck
12. Rear lawn – Looking southeast from southwest corner of pool deck

---

**Property Owner:**

(Complete this item at the request of the SHPO or FPO.)

name Terri Miller  
street & number 919 La Loma Road telephone \_\_\_\_\_  
city or town Pasadena state CA zip code 91105

**Paperwork Reduction Act Statement:** This information is being collected for applications to the National Register of Historic Places to nominate properties for listing or determine eligibility for listing, to list properties, and to amend existing listings. Response to this request is required to obtain a benefit in accordance with the National Historic Preservation Act, as amended (16 U.S.C.460 et seq.).

**Estimated Burden Statement:** Public reporting burden for this form is estimated to average 18 hours per response including time for reviewing instructions, gathering and maintaining data, and completing and reviewing the form. Direct comments regarding this burden estimate or any aspect of this form to the Office of Planning and Performance Management, U.S. Dept. of the Interior, 1849 C. Street, NW, Washington, DC.

Richard & Mary Alice Frank Garden  
Name of Property

Los Angeles County, CA  
County and State

**SKETCH MAP**

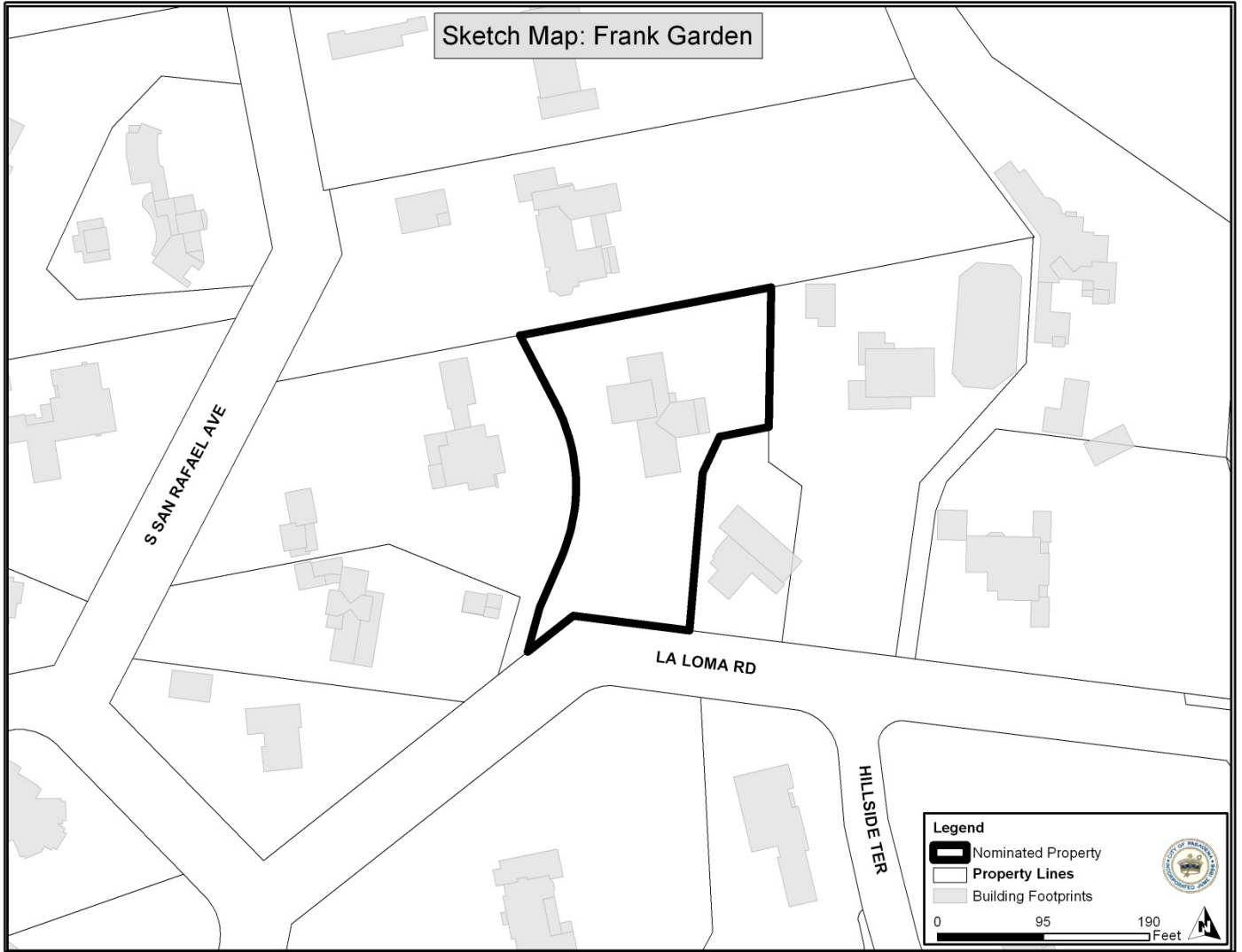



Richard & Mary Alice Frank Garden  
Name of Property

Los Angeles County, CA  
County and State

**AERIAL MAP**

